Comfort-Aire®

Century®

MARS
Delivering Confidence

PARTS LIST

Horizontal/Side Discharge Condensing Units

CMA12SD-0

EXPLODED VIEW

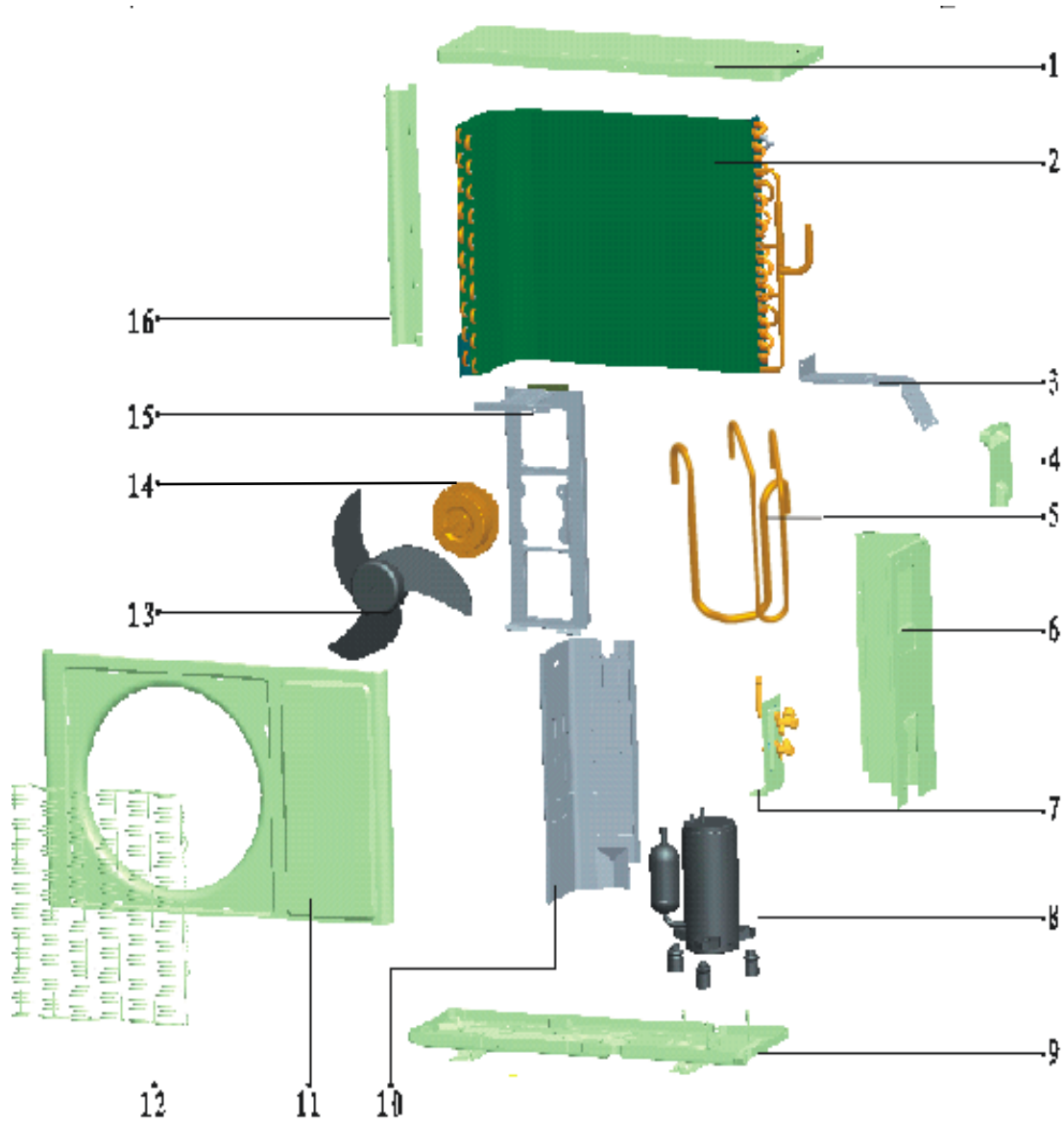

REPLACEMENT PARTS

Location	Part Name	Part No.
1	Cover	801227490015
2	Condenser assy	801527490004
2.1	Condenser	801527490005
2.2	condensor collecting pipe assy	801627490015
2.3	distributing capillary assy	801627490018
3	E-parts assy	803327490003
3.1	Capacitor clamp	801200100007
3.2	Groove clamp 3#	801102000015
3.3	Installation board for E-parts	801227400021
3.4	Terminal	802401800090
3.5	Compressor capacitor	802401000063
3.6	Fan capacitor	802401100082
3.7	SESOR	802301000009
3.8	AC contactor	802300100253
4	Handle	801219900166
5	Pipeline components	801627490024
5.1	Compressor back to the trachea	801627490025
5.2	Compressor exhaust pipe	801627490026
6	Right clapboard	801227800056
7	Valve holder assy	801232400020
7.1	Valve holder	801219900278
7.2	Cut-off valve	801619900095
7.3	Cut-off valve	801619900094
8	Compressor assy	801401400154
9	Chassis	801227490013
10	Separating board	801232000023
11	Front panel	801232400067
12	Front top net	802900800076
13	Propeller fan	801100300009
14	Fan motor	802400400703
15	Holder for fan motor	801219900112
16	Vertical shaft	801219900346
17	Pressure switch	802300900041
18	Compressor capacitor	802401000063
19	Fan motor capacitor	802401100082

Due to ongoing product improvements, specifications and dimensions are subject to change and correction without notice or incurring obligations. Determining the application and suitability for use of any product is the responsibility of the installer. Additionally, the installer is responsible for verifying dimensional data on the actual product prior to beginning any installation preparations.

Incentive and rebate programs have precise requirements as to product performance and certification. All products meet applicable regulations in effect on date of manufacture; however, certifications are not necessarily granted for the life of a product. Therefore, it is the responsibility of the applicant to determine whether a specific model qualifies for these incentive/rebate programs.

Comfort-Aire®

1900 Wellworth Ave., Jackson, MI 49203 • Ph. 517-787-2100 • www.marsdelivers.com

